

Instruction for Use

Trade Name: Cassette Stand

Contraindication/Prohibition

Ensure all clamp handles are tight. Failure to do so may result in a patient injury.

Shape/ Structure

1. External view

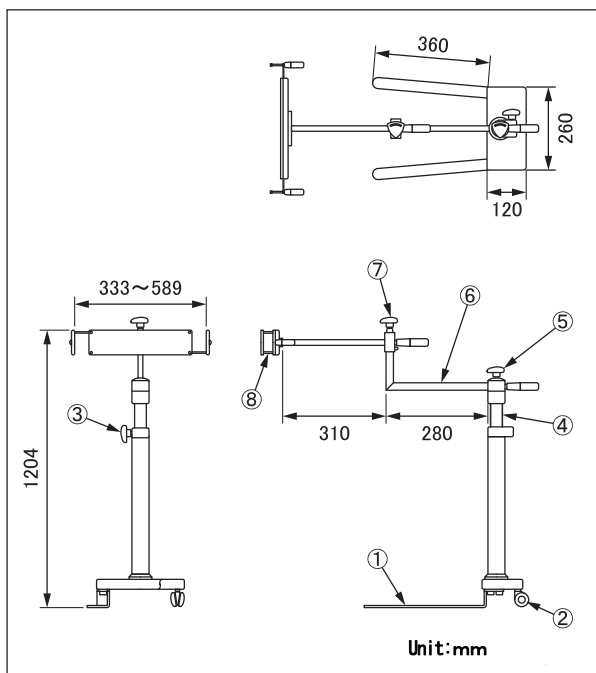

Code No.	Product Description
08-090-01	Cassette Stand

2. Weight (excluding pad)

20.0 kg

3. Material

- ① Base: Stainless steel plates
- ② Casters: Synthetic rubber
- ③ Clamp handle: Stainless steel rod/Synthetic resin
- ④ Stand : Stainless steel rod
- ⑤ Clamp handle: Stainless steel rod/Synthetic resin
- ⑥ Arm : Stainless steel rod
- ⑦ Clamp handle: Stainless steel rod/Synthetic resin
- ⑧ Attachment: Stainless steel plates

Note: Reference numbers are corresponding to that indicated in

1. External view shown above.

4. Function

Elevation range: 360mm

Sliding: Arm 280mm / Attachment 310mm

Intended Purpose

This is an accessory to an operating table to support the x-ray cassette holder in radiography.

Instructions for use

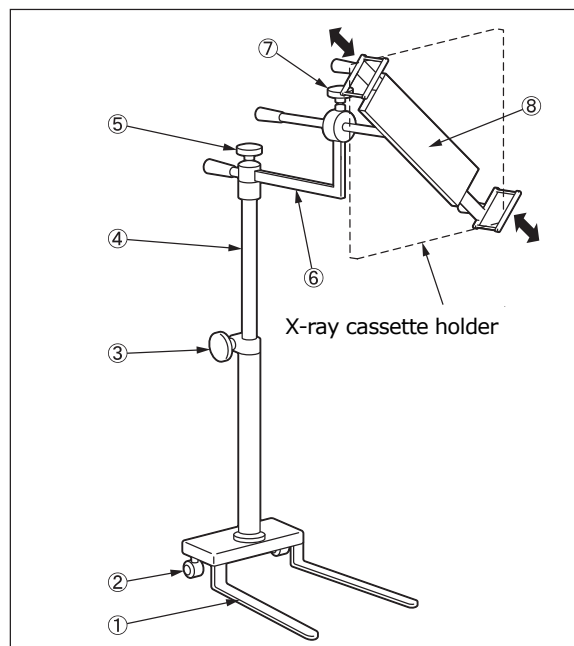

1. Operate the clamp handle ③ and adjust the height of stand ④.
2. Operate the clamp handle ⑤ and adjust the length of arm ⑥.
3. Operate the clamp handle ⑦ and adjust the position of attachment ⑧.
4. Move the base ① to the necessary position using the caster ②.
5. Operate the clamp handle ⑦ and set the attachment ⑧ as shown in the figure above.
6. Adjust the size of the attachment ⑧ to fit the cassette holder as shown by the arrows in the figure above. Operate the clamp handle ⑦ to secure the x-ray cassette holder.

Caution

Important caution

When working with an operating table, take care not to allow this product to make contact or interfere with the table top or with other tools and appliances used in combination with this product.

Storage and Shelf Life

1. Do not store the device in high temperatures or in areas with high humidity where the temperature has drastic variations.
2. Service life of this product: 7 years
(subject to the specified maintenance and inspection and is stored properly)

Maintenance/Inspection

1. Check that this product is not damaged or broken before and after use.
2. Cleaning and disinfection
Wipe off blood, chemicals, contaminants, and other stains with water, and clean the device with gauze or other material moistened with alcohol to disinfect.
3. In case of a malfunction
If you need to have this product repaired, clearly label the device as "Broken", "Need repair" etc. and contact your local dealer or Mizuho.

<By agents>

Maintenance and inspection can only be carried out by certified agents of MIZUHO.

Packing

1 pieces per pack

Matters related to warranty period

MIZUHO Corporation will repair defective parts of this product without charge for one year from the date of delivery/installment except for cases of damage caused by a third party's repair, act of nature, improper use or damage on purpose. All other warranty terms and conditions are subject to regulations of MIZUHO Corporation

Name and address of manufacturer

MIZUHO Corporation
3-30-13 Hongo, Bunkyo-ku, Tokyo 113-0033, Japan
<http://www.mizuho.co.jp>