



MT-900 Series Cuff Instruction for Use

Table of Contents

1. Introduction	2
2. Component Identification	4
3. Operation	5
4. Inspection and Maintenance	6
5. Specifications.....	7



CAUTION

Be sure to read this instruction manual before using this product.
Keep this manual available for reference when needed.

1. Introduction

1-1. Intended Use

This product is a band-shaped tourniquet which is attached to upper and lower limbs (arms or legs) during an operation in order to obtain a bloodless surgery field by suppressing the circulation of blood, or cutting off normal blood flow to and from a distal part. This product is used together with a hemostatic device to adjust pressurization.

This product is suitable for use in the operating room by surgeons, nurses, and medical device technicians who are acquainted with the usage of this product.

1-2. Important Notices

To ensure safe operation and proper functionality, please read the following instructions thoroughly before use and follow them carefully. Failure to follow these instructions could lead to serious injury of the patient or the user or damage to this product.



CAUTION

This indicates content in which people could be assumed to suffer from difficulties if this product is incorrectly handled and content in which physical damage could be assumed to occur.

- Check the exterior of this product before use, and if there are any abnormalities, do not use this product. Air leaks, etc. may hinder the arrest of the bleeding.
 - Do not use this product for other purposes than hemostasis of limbs. It is usage outside the purpose.
 - Use the tourniquet body and related products which are designated by MIZUHO Corporation. Air leaks, etc. may hinder the arrest of the bleeding.
 - Do not use this product with excessive pressure. If arresting bleeding with excessive pressure, it may cause damage to tissue, etc.
-

2. Component Identification



Single Cuff

Double Cuff

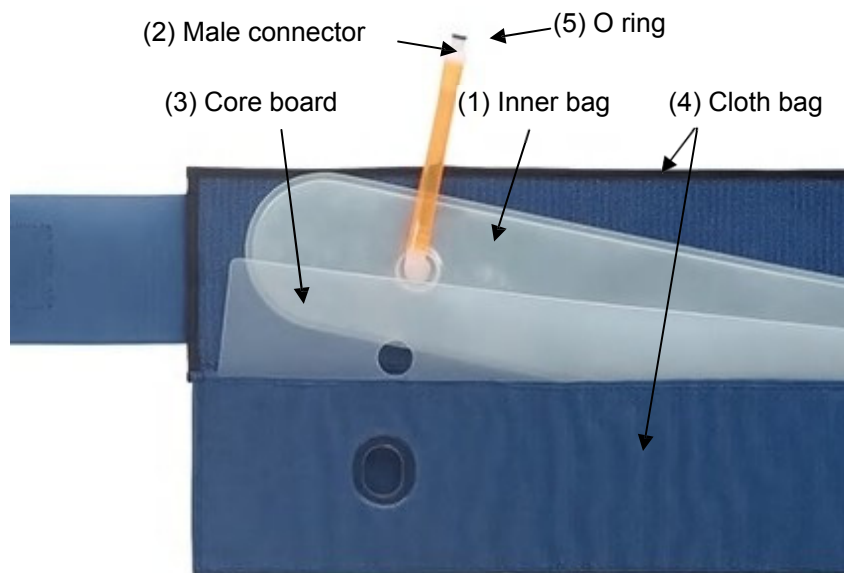

Component		Material
(1)	Inner bag	Resin
(2)	Male connector	Resin
(3)	Core board	Resin
(4)	Cloth bag	Cotton
(5)	O ring	Rubber

3. Operation

Attachment / Detachment

1. Select a cuff of the appropriate length and width to fit the patient and operative method.
2. Wrap the tourniquet closely around the proximal ends of both upper and lower limbs to the extent that the subcutaneous vein would not be overswelled.
(If the tourniquet is wrapped with either excessive or insufficient tightness, it may reduce hemostatic effects.)
3. Use the dedicated cuff hose to connect the tourniquet body to related products.
4. After use, check that no pressure remains in the cuff, and then remove the tourniquet body and related products.

(Caution)

- A thick underlay may reduce hemostatic effects.
- If a medicinal solution, such as Iodine, is attached to the cuff and the cloth bag of the cuff is hardened, it may cause poor hemostasis. For cleaning, refer to (4. Cleaning and inspection).
- Before use, check the connection of the cuff, cuff hose, tourniquet body and related products again.
- Look out for bent tubes, etc. during use.
- Be sure to refer to the instruction manual of the tourniquet body to be used.

4. Inspection and Maintenance

4-1. Inspection Before and After Use

- Check that this product is not damaged or broken before and after each use.

4-2. Cleaning and Disinfection

1. Take the core board and inner bag out of the cloth bag. Inspect the core board and inner bag for cracks and ruptures, and check whether the connecting section of the connector is loose.
2. Wipe clean any stains on the core board and inner bag with alcohol to sterilize. Pay due attention so that water does not penetrate the inner bag.
3. Hand wash the cloth bag with neutral detergent, rinse it thoroughly with fresh water, and then dry it.
When washing it in a washing machine, put the cloth bag in a laundry net. (The cloth bag may be discolored when washed.)
4. Refer to the figure below to correctly assemble the cleaned cuff so that the inner bag does not become twisted or bent. (If it has a twist or bend, it may cause poor hemostasis.)

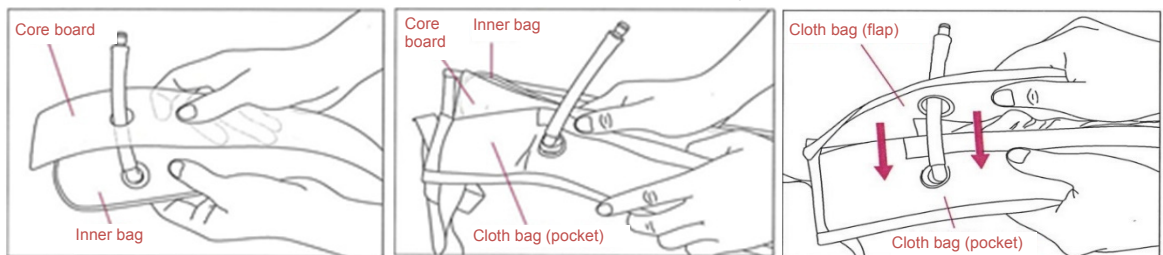

(1) Thread the hose attached to the inner bag through the hole in the core board.

(2) Put the inner bag and core board on top of one another and thread the hose through the hole in the cloth bag, and then, put them into the pocket of the cloth bag.

(3) Thread the hose through the hole on the flap (lid) of the cloth bag and close the flap to complete.

5. Sterilize the cuff under standard sterilization conditions with ethylene oxide gas sterilization or under sterilization conditions verified by medical institutions. Do not perform high-pressure steam sterilization or hydrogen peroxide low-temperature gas plasma sterilization.

4-3. Repair and Maintenance

- When this product seems broken, attach a label, such as “faulty,” “use prohibited,” or “repair required” on the product, and contact your sales agent or MIZUHO Corporation.
- Only MIZUHO Corporation or an agent authorized by MIZUHO Corporation can repair or maintain this product. If this product is repaired or maintained by any other agent, it may cause adverse events, or deterioration of performance and function. However, the replacement of the O ring is not subject to this requirement. Replace the O ring with the following procedure.
 1. Check that the O ring is not cracked or deteriorated. If it has any cracks or deterioration, it may cause air leaks.
 2. If the O ring is cracked or deteriorated, immediately replace it by referring to the figure below.
 - (1) Remove the O ring using a tool with a thin and flat tip, such as a small flat-blade screwdriver.
 - (2) Attach a new O ring by hooking one end into the groove, and then hold the O ring with your fingers while expanding it to extend the other end into the groove. (Be careful so as not to get injured.)

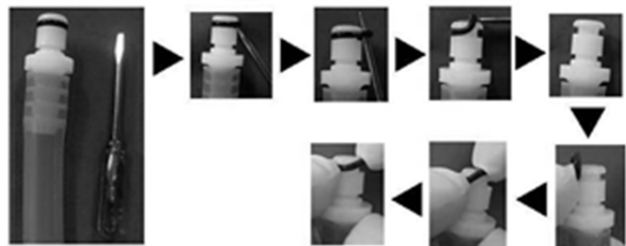

4-4.Warranty

- MIZUHO Corporation will repair defective parts of this product without charge for one year from the date of delivery / installment except for cases of damage caused by a third party's repair, act of nature, improper use or intentional damage. All other warranty terms and conditions are subject to the regulations of MIZUHO Corporation.

4-5. Disposal

- Follow the local regulations when disposing of this product.

5. Specifications

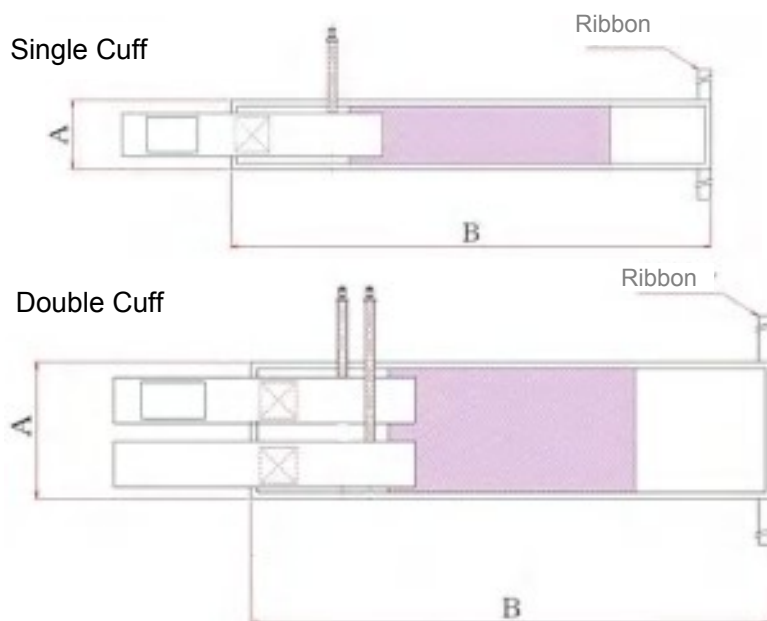

Product Code	Product Description	External Dimensions		Applicable Circumference	Ribbon color	Remarks
		Width A	Length B			
01-448-01	MT900 Single Cuff 50 × 260mm	50	260	100 to 140	Light gray	No core board
01-448-02	MT900 Single Cuff 50 × 320mm	50	320	130 to 190	Dark blue	No core board
01-448-03	MT900 Single Cuff 80 × 440mm	80	460	190 to 260	White	—
01-448-04	MT900 Single Cuff 80 × 550mm	80	580	250 to 360	Light blue	—
01-448-05	MT900 Single Cuff 80 × 720mm	80	750	350 to 490	Yellow	—
01-448-06	MT900 Single Cuff 105 × 570mm	105	600	250 to 350	Blue	—
01-448-07	MT900 Single Cuff 105 × 750mm	105	780	350 to 500	Dark gray	—
01-448-08	MT900 Single Cuff 105 × 1050mm	105	1040	500 to 700	Brown	—
01-448-09	MT900 Single Cuff 105 × 1350mm	105	1390	700 to 980	Black	—
01-448-10	MT900 Double Cuff 150 × 550mm	150	580	250 to 360	Light blue	—
01-448-11	MT900 Double Cuff 150 × 720mm	150	750	350 to 490	Yellow	—
01-448-12	MT900 Double Cuff 200 × 1000mm	200	1040	500 to 700	Brown	—
01-448-13	MT900 Double Cuff 100 × 260mm	100	260	100 to 140	Light gray	No core board
01-448-14	MT900 Double Cuff 100 × 320mm	100	320	130 to 190	Dark blue	No core board

(Unit: mm)

Five O rings (product code: P01-447-20) are attached to the cuff.

Dimension	Described in the figure on Page 8	
Operating environment	Temperature	10 °C to 40 °C
	Relative Humidity	30 % to 75 %
	Atmospheric Pressure	700 hPa to 1060 hPa
Transportation and Storage Environment	Temperature	-10 °C to 50 °C
	Relative Humidity	10% to 85%
	Atmospheric Pressure	700 hPa to 1060 hPa
Service Life	2 years (when subjected to the specified maintenance and inspection stored properly)	



Sales Agent

Manufacturer:



MIZUHO Corporation

3-30-13 Hongo, Bunkyo-ku
Tokyo 113-0033, Japan
<http://www.mizuho.co.jp>